

GAS HEADER KIT

Imax Xtra EL 715 - 1240

These instructions must be read in conjunction with the Installation & Servicing Instructions supplied with the boiler.

KIT CONTENTS

- A. Header - 1 off
- B. DN80 Blank Flange - 1 off
- C. DN50 Gasket - 2 off
- D. Test Nipple - 1 off
- E. M16 x 60 Bolts - 12 off
- F. M16 Nuts - 12 off
- G. DN50 Screw on Flange - 2 off
- H. DN80 Gasket - 1 off

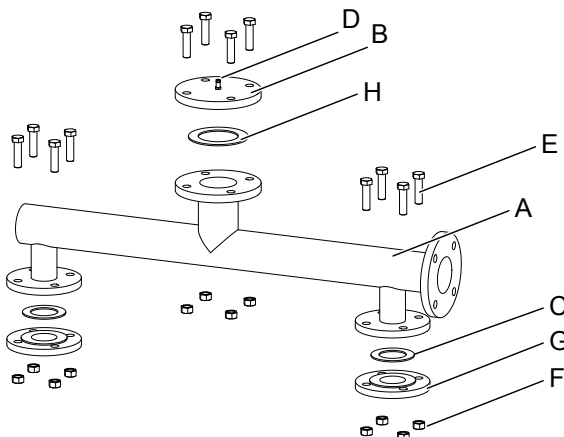

INSTALLING THE GAS HEADER KIT

1. Screw on the DN50 flanges onto the Master and Slave gas Inlet pipes using an appropriate sealing compound.
2. Connect the DN80 blank flange onto the manifold inlet that is not going to be used ensuring the DN80 gasket is fitted.
3. Connect the header onto the gas inlets of the appliance ensuring the DN50 gaskets are fitted.
4. Once all the fittings are connected, check for gas leaks on any of the joints.

